

HYUNDAI

ELEVATOR(CHINA) CO., LTD.



Scan the QR code
to login to Hyundai
Elevator website



Scan the QR code to
follow the Hyundai
elevator wechat account

China Sales Office

8F, Block C, The MIXC, No.1799, Wuzhong Road, Minhang District, Shanghai, China
Phone: +86-21-64858600 51600150
Website: www.hyundailevator.com.cn

China Factory

No.390, Jinqiang Road, Jinshan Industrial District, Shanghai, China
Phone: 400-821-1228

Hyundai Elevator Co., Ltd.

Korea Headquarters and Factory

128, Chungjusandan 1-ro, Chungju-si, Chungcheongbuk-do, Korea
Phone: +82-43-722-1000
Fax: +82-43-722-1001

Korea Sales Office

Hyundai Group Building, 194, Yulgok-ro, Jongno-gu, Seoul, Korea
Phone: +82-2-3670-0659
Fax: +82-2-3672-8763/4

This catalogue is for general information purposes only and we reserve the right to change the product design and specifications at any time. The information contained in this catalogue does not constitute any warranty or undertaking, express or implied, as to the suitability, merchantability, or quality of the products and their particular applications, nor shall it be deemed to be a term of any agreement for the purchase of products or services therein. Printed colors may be slightly different from actual colors.

Copyright© 2023 HYUNDAI Elevator
YZER-H Home Elevator | January, 2023

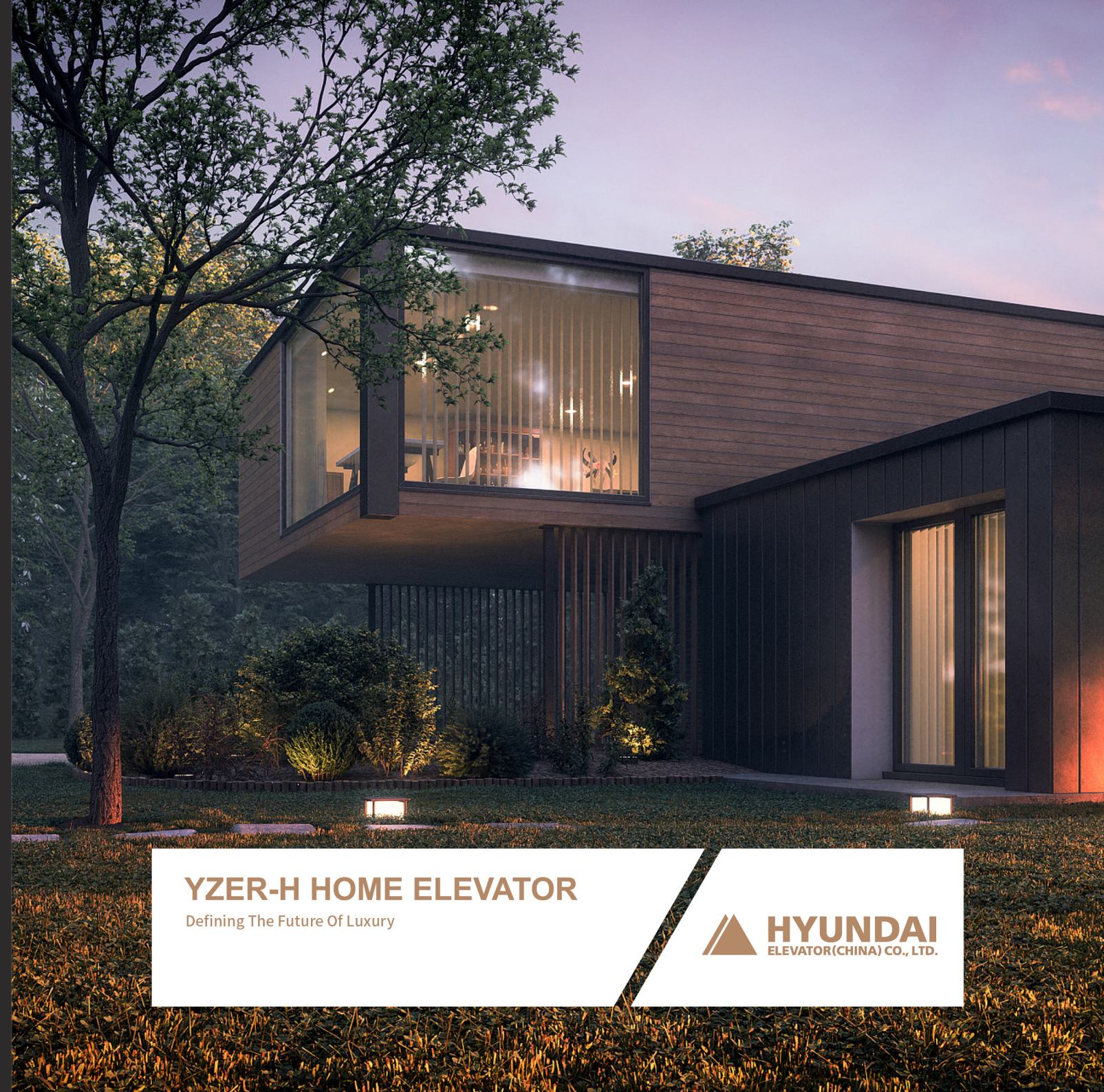

YZER-H HOME ELEVATOR

Defining The Future Of Luxury



Global Top 100 Brands

High-Quality Life
Created By Hyundai

10

Top 10 elevator
manufacturers
in the world

14

Leading the Korean
market for 14
consecutive years

4

China rank 4th
in exports

21^{m/s}

21m/s carbon
fiber belt elevator
technology

10^{m/s}

10m/s super high-
speed double cabin
elevator

70

With more than 70 years
of unremitting efforts,
Hyundai has become a
world-renowned
elevator brand.

Enjoy The Life With Intelligent Technology

Eight intelligent technologies



Artificial Intelligence
Technology



Intelligent Lighting Technology
(Automatic Lighting,
Atmospheric Lighting)



Intelligent Audio and
Video Technology
(LCD Display + Voice
Announcement)



Intelligent Communication
Technology (One-Touch Call
For Help)



Intelligent Perception
Technology (Face
Recognition)



Intelligent Security
Technology (Camera
Monitoring)



Intelligent HVAC
technology (Elevator
Air Conditioning)



Intelligent Sensing
Technology (Pre-Opening
For Arrival)

Green Care For Safety Guarantee



Air Purification Solution From Korea

- Release negative ions to purify the air.
- Repel mosquitoes and enhance the experience of taking elevators.
- All-in-one design, more reliable security.



Anti-Bacterial Handrail

- Special anti-bacteria material to protect the safety of the passengers.

6 Major Safety Protection Functions



Power outage
emergency
protection



Safety circuit
protection



Infrared
induction
protection



One-touch
call for help



Mechanical
safety
protection



Anti-slip
protection

Leading Trend With Humanistic Design

Industrial Design Strength

The brand is created with a blend of freedom, creativity and exquisite craftsmanship. Each object is designed to stand up to the test and adapt to changing lifestyles.

Hyundai Elevator won consecutive titles in the "German Red Dot Design Award", which is called the Oscar of industrial design awards.

It is also an elevator brand that has won 3 major industrial design awards consecutively.



Modern Cabin Design

Modern, Simple And Delicated Life.

Pursue Simple Life Art, Abandon Flashy Decoration, Reserve Pure Life Spirit.



CAR-001

- Ceiling: STS Hairline + LED Lights
- Car Wall: Steel Plate SP007 + SP004
- Handrail: Without
- Car Door: Steel Plate SP004
- Car Operating Panel: VOP-TA100 (Standard)
- Flooring: PVC (Ash Infinite Gray)

There will be slight difference between the sample photo and the real thing, everything is subject to the real thing.

Modern Cabin Design



CAR-002

- Ceiling: Hidden Lights + STS Hairline Champagne Gold Decorative Strips+Paint (Ivory White)+Downlights
- Front Wall: Solid Wood
- Side Wall: Solid Wood
- Rear Wall: Solid Wood + Light Strips
- Handrail: Without
- Car Door: STS Hairline
- Car Operating Panel: VOP-TA100 (Standard)
- Flooring: Marble By Others

There will be slight difference between the sample photo and the real thing, everything is subject to the real thing.



CAR-003

- Ceiling: STS Mirror+Downlights
- Front Wall: Wood Pattern Film (SP004)
- Side Wall: Wood Pattern Film (SP004)+ Wood Pattern Film (SP015)
- Rear Wall: Wood Pattern Film (SP004)+ Wood Pattern Film (SP015)
- Handrail: Without
- Car Door: Wood Pattern Film (SP004)
- Car Operating Panel: VOP-TA100 (Standard)
- Flooring: PVC

There will be slight difference between the sample photo and the real thing, everything is subject to the real thing.





Light Luxury Cabin Design

Simple And Light Luxury With High- Quality Texture.

Consideration On Every Details Brings Back Good Texture, It Can't Be Too
Elaborate To Get High-Quality Life.

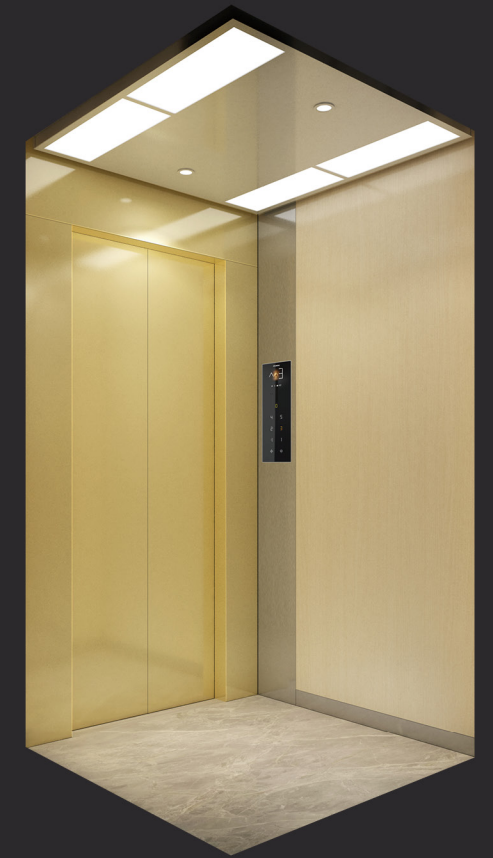

CAR-004

- Ceiling: STS Hairline+Acrylic+Light Strips+Downlights
- Front Wall: TI-Gold STS Hairline
- Left Side Wall: TI-Gold STS Hairline + STS Hairline
- Right Side Wall: TI-Gold STS Hairline + STS Mirror
- Rear Wall: STS Mirror + STS Mirror Etching +
TI-Gold STS Hairline
- Handrail: Without
- Car Door: TI-Gold STS Hairline
- Car Operating Panel: VOP-TA100 (Standard)
- Flooring: PVC (Granite Gray)

There will be slight difference between the sample photo
and the real thing, everything is subject to the real thing.

Light Luxury Cabin Design



CAR-005

- Ceiling: Solid Wood, Hidden Light Strips
- Front Wall: Solid Wood
- Side Wall: Solid Wood, Palpable Leather
- Rear Wall: Solid Wood + Light Strips
- Handrail: Without
- Car Door: STS Hairline
- Car Operating Panel: VOP-TA100 (Standard)
- Kick Plate: Silver Metallic
- Flooring: Marble By Others

There will be slight difference between the sample photo and the real thing, everything is subject to the real thing.



CAR-006

- Ceiling: STS Hairline + LED Downlights
- Front Wall: STS Hairline
- Side Wall: Steel Plate SP002 + STS
- Rear Wall: Steel Plate SP002+Steel Plate SP017+STS Strips
- Handrail: Without
- Car Door: STS Hairline
- Car Operating Panel: VOP-TA100 (Standard)
- Flooring: PVC (Creamy White)

There will be slight difference between the sample photo and the real thing, everything is subject to the real thing.





Chinese Style Cabin Design

Chinese Elegance Spiritual Content.

Adhering To The Concept Of Oriental Esthetics, It Allows Those Who Pursue
Quality Life To Be One Step Closer To Their Dream of Poetic Home.



CAR-007

- Ceiling: Wood Pattern Film + Silk-Screen Acrylic
- Front Wall: TI-Bronze STS Hairline
- Side Wall: Wood Strips + Wood Pattern Film
+ TI-Gold STS Mirror + Wooden Grid
- Rear Wall: Wood Strips + Wood Pattern Film +
TI-Gold STS Mirror
- Handrail: Wood + TI-Gold STS Mirror
- Car Door: TI-Bronze STS Hairline
- Car Operating Panel: VOP-TA100 (Standard)
- Flooring: Marble By Others

There will be slight difference between the sample photo
and the real thing, everything is subject to the real thing.

Observation Cabin Design

Dainty And Exquisite Life.

Lying Quietly In Rocking Chair, Putting On The Earphones, Being Intoxicated With The Beautiful Melody Of Music, Following Song Passing Through Realm As If Being There.

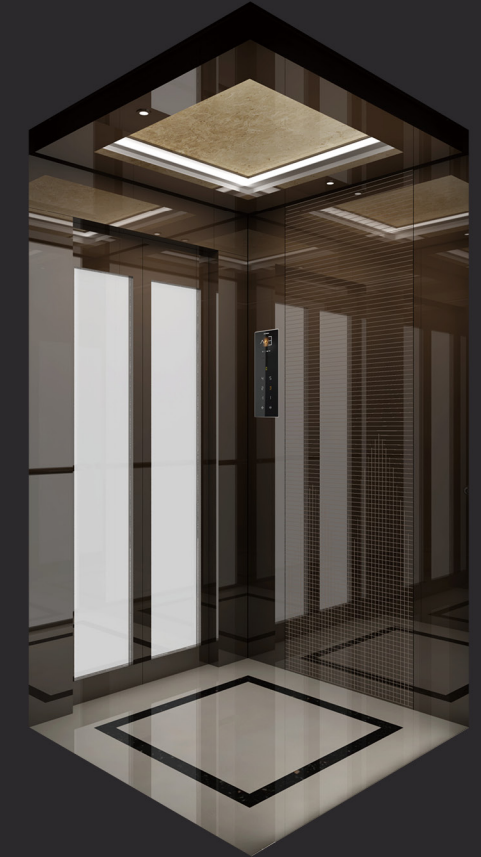

CAR-008

- Ceiling: Hidden Lights + Gold Foil + Wood Strips + TI-Bronze STS Mirror + LED Downlights
- Front Wall: TI-Bronze STS Mirror
- Side Wall: TI-Bronze STS Mirror + TI-Bronze STS Mirror Etching
- Rear Wall: Safety Glass + TI-Bronze STS Mirror
- Handrail: TI-Bronze STS Mirror Round type
- Car Door: TI-Bronze STS Mirror
- Car Operating Panel: VOP-TA100 (Standard)
- Flooring: Marble By Others

There will be slight difference between the sample photo and the real thing, everything is subject to the real thing.

Electrical Fixtures



VOP-TA100 (Standard)

Metallic Texture With Narrow Frame
Tempered Glass Faceplate
5 Inch TFT Display
Touch Button, Slight White Illumination During Standby, Orange Illumination After Touch it
Mounted Type

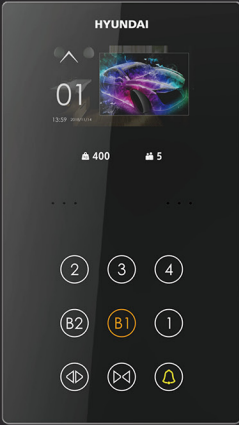

VOP-TB100 (Option)

Metallic Texture With Narrow Frame
Tempered Glass Faceplate
7 Inch TFT Display
Touch Button, Slight White Illumination During Standby, Orange Illumination After Touch it
Wall-Mounted Type



VOP-TD100 (Option)

13 Inch Touch Screen
Weather, Date & Day-Time Limit Display
Chinese And English Two Languages
Voice Synthesizer, One-Touch Dialing For Rescue
Image Display, Audio & Video Play, Nameplate & Logo Display
Door Open Button, Integrated Emergency Lighting
Surface-Mounted Type

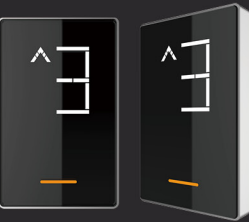

VIB-TA100 (Standard)

Metallic Texture With Narrow Frame
Tempered Glass Faceplate
Segment Display
Touch Button, Slight White Illumination During Standby, Orange Illumination After Touch it
Wall-Hanging Type



VIB-TB100 (Option)

Tempered Glass Faceplate
3.5 Inch TFT Display
Touch Button
Wall-Hanging Type



VIB-TC100 (Option)

4.2 Inch TFT Display
Elevator Status, Direction, Landing Position Display (Real Time)
Touch Button, Illumination After Touch it
White Display On Black Background
Wall-Hanging Type



VIB-TD100 (Option)

Metallic Texture With Narrow Frame
Tempered Glass Faceplate
Segment Display
Touch Button, Slight White Illumination During Standby, Orange Illumination After Touch it
Wall-Hanging Type

Landing Door

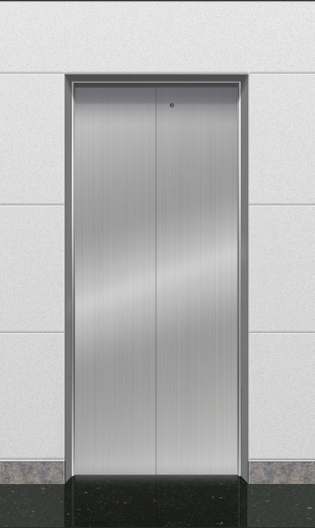

STS Hairline



TI-Gold STS Hairline

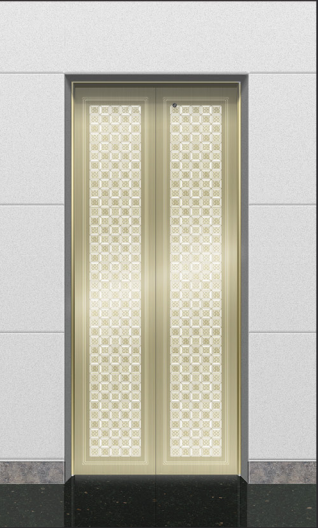

TI-Gold STS Hairline Etching



STS Mirror

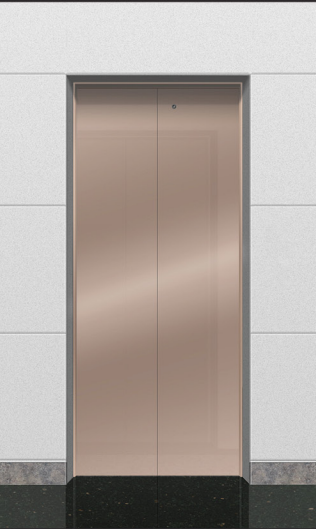

TI-Rose Gold STS Mirror

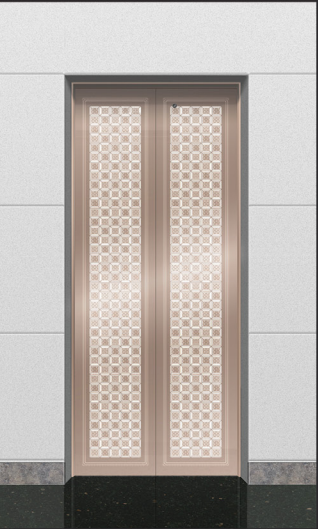

TI-Rose Gold STS Mirror Etching

Ceiling

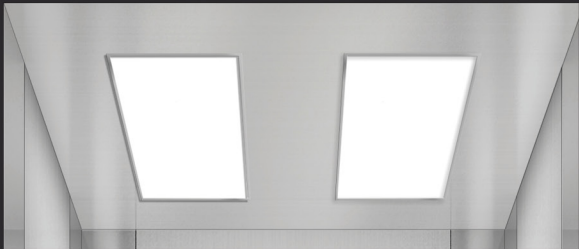

C013
STS Hairline, 300*600 Panel Lights



C014
STS Hairline, 200*200 Panel Lights

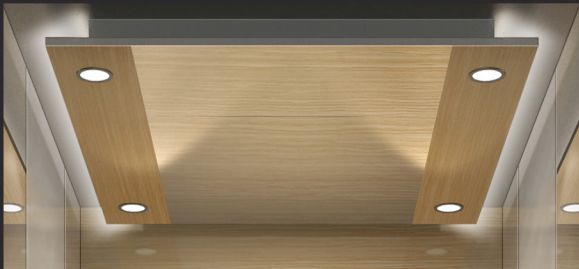

C016
STS Mirror, Wood Pattern Film W010, LED Downlights, LED Hidden Lights

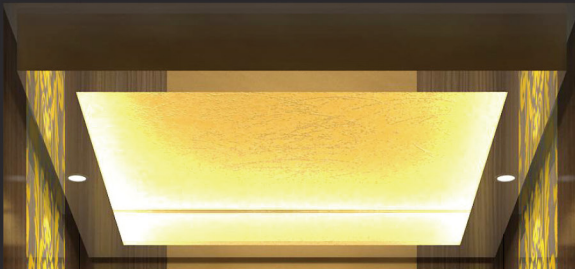

C021
STS Mirror, Decorative Film W013, LED Downlights, LED Hidden Lights

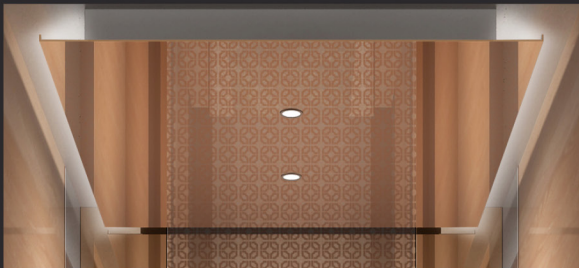

C024
STS Mirror, LED Downlights, LED Hidden Lights

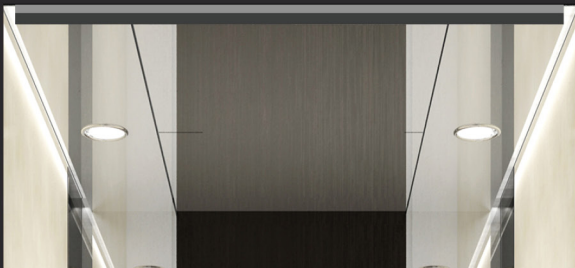

C025
STS Mirror, LED Downlights, LED Hidden Lights

There will be slight difference between the sample photo and the real thing, everything is subject to the real thing.

Handrail



HR-009
STS Mirror, Wood Pattern Film

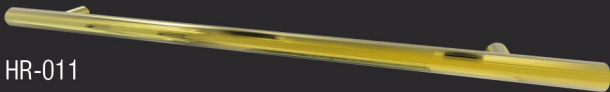

HR-011
TI-Gold STS Mirror Etching

Note: 1. There will be slight difference between the sample photo and the real thing, everything is subject to the real thing.
2. For some technical reasons, the types of home elevators and other elevators may be different.

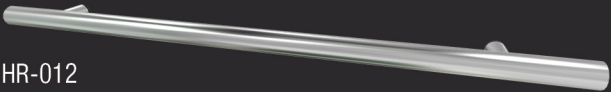

HR-012
STS Hairline

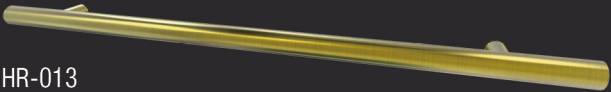

HR-013
TI-Gold STS Hairline

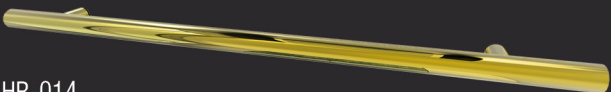

HR-014
TI-Gold STS Mirror

Flooring

PVC



F-P007



F-P010

Marble



F-M110

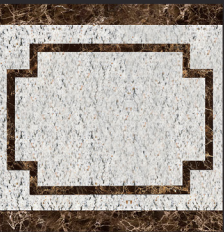

F-M105

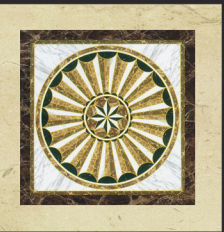

F-M107

There will be slight difference between the sample photo and the real thing, everything is subject to the real thing.

Center Opening Layout

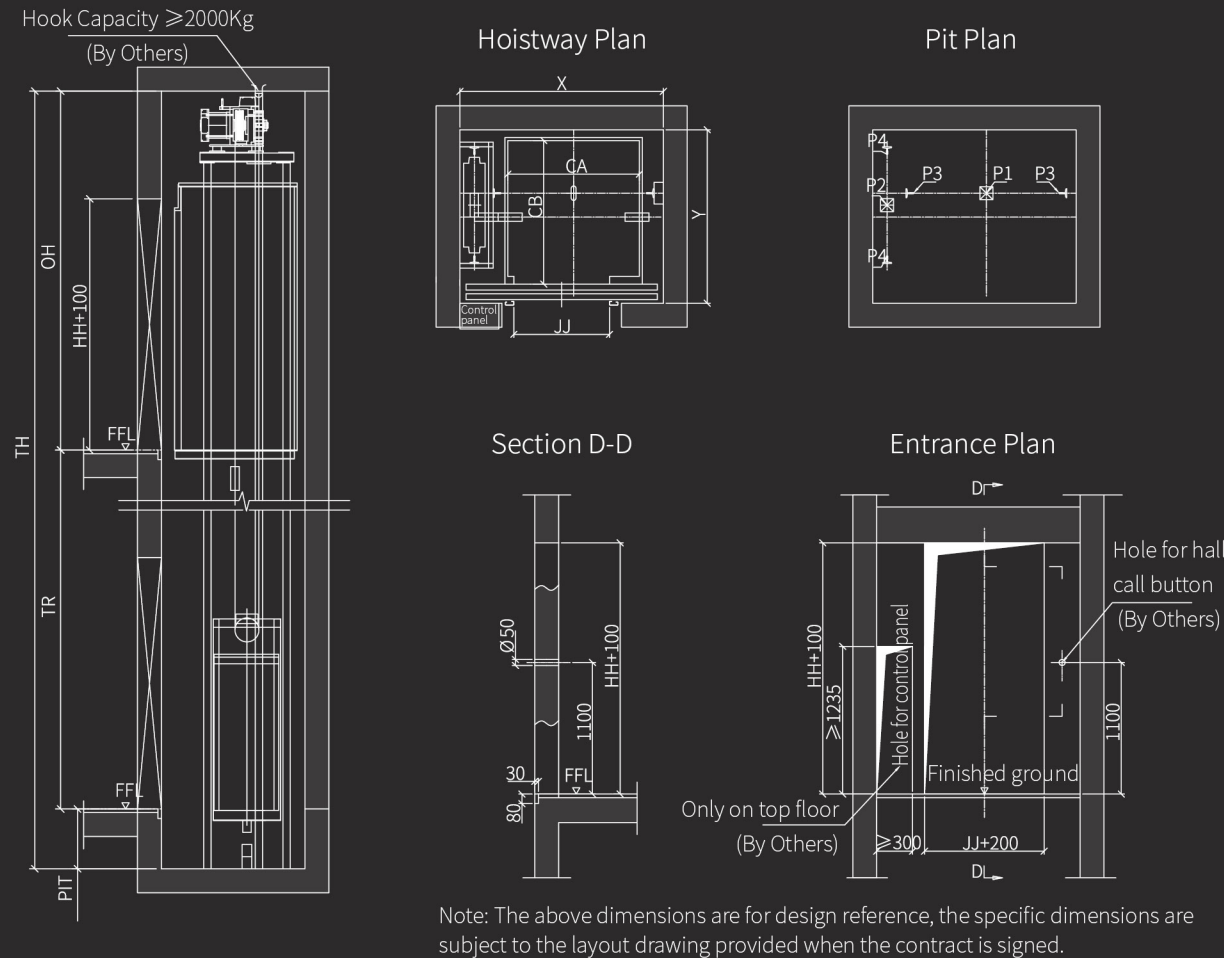

Standard Specifications

Unit: mm

Number of People	Rated Capacity (kg)	Rated Speed (m/sec)	Hoistway Size (X,Y)	Car Insize (CA,CB,CH)	Opening Size (JJ,HH)	Min. Overhead (OH)	Min. Pit (PIT)
3	250	0.4	1400x1250	800x1000x2200	600x2000	2900 (2700)	500(250)
3	250	0.4	1550x1250	950x1000x2200	700x2000	2900 (2700)	500(250)
4	320	0.4	1550x1350	950x1100x2200	700x2000	2900 (2700)	500(250)
4	320	0.4	1750x1350	1150x1100x2200	800x2000	2900 (2700)	500(250)
5	400	0.4	1550x1450	950x1200x2200	700x2000	2900 (2700)	500(250)
5	400	0.4	1750x1450	1150x1200x2200	800x2000	2900 (2700)	500(250)

Note: 1. For side opening type it will be calculated according to different requirements.
2. The limited size in brackets is for reference. Multiple non-standard sizes will cause interference problems. For details, please refer to the layout drawings.

Side Opening Layout

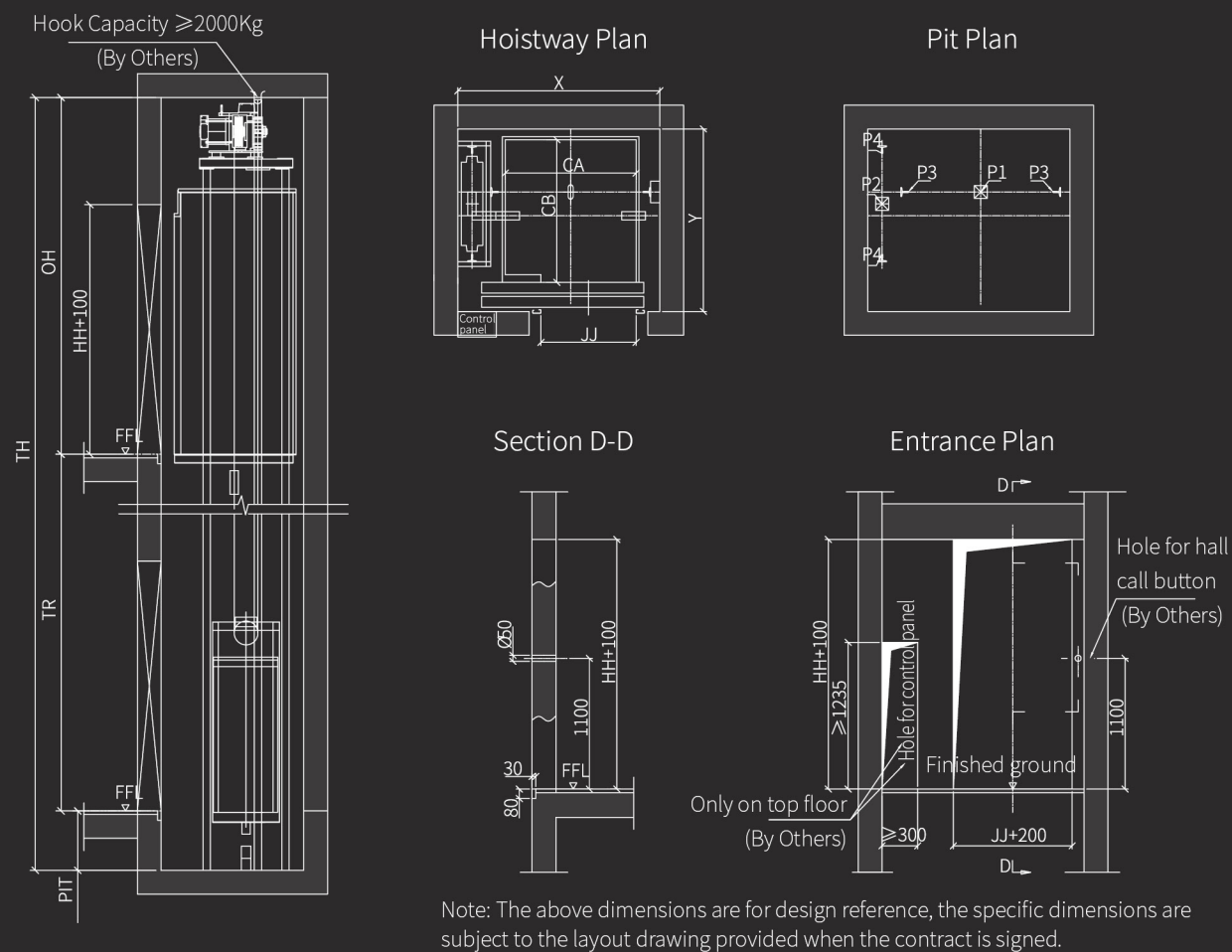

Standard Specifications

Unit: mm

Number of People	Rated Capacity (kg)	Rated Speed (m/sec)	Hoistway Size (X,Y)	Car Insize (CA,CB,CH)	Opening Size (JJ,HH)	Min. Overhead (OH)	Min. Pit (PIT)
3	250	0.4	1450x1350	850x1000x2200	700x2000	2900 (2700)	500(250)
3	250	0.4	1550x1350	950x1000x2200	800x2000	2900 (2700)	500(250)
4	320	0.4	1550x1450	950x1100x2200	700x2000	2900 (2700)	500(250)
4	320	0.4	1750x1450	1150x1100x2200	800x2000	2900 (2700)	500(250)
5	400	0.4	1550x1550	950x1200x2200	800x2000	2900 (2700)	500(250)
5	400	0.4	1750x1550	1150x1200x2200	800x2000	2900 (2700)	500(250)

Note: 1. For center opening type it will be calculated according to different requirements.
2. The limited size in brackets is for reference. Multiple non-standard sizes will cause interference problems. For details, please refer to the layout drawings.

Intelligent Manufacturing With Quality Assurance



World-Class
Test Center



Smart
Factory



High-Quality
Products



Flexible
Production

电梯功能表

24 小时服务热线：

400 8211 228

服务网络已覆盖全国大部分省市，
向客户提供快捷、高效的专业服务。

平稳运行	全面保护	舒适乘梯
全集选功能	光幕信号自诊断	开门时间设定
关门按钮提前关门	重复关门功能	空闲返基站功能
楼层显示设置	低速自救功能	按钮粘连功能
空闲返基站功能	运行次数记录	启动转矩自动补偿
换站停靠功能	运行时间记录	直接停靠
○ 锁梯功能	门锁异常自动开门	最佳曲线自动生成
	超载保护功能	
	故障数据记录	定制化乘梯
井道自学习功能	飞车禁止功能	门服务层设置
电机参数调谐	优先放人功能	误指令删除功能
楼层位置智能校正	○ 消防迫降功能	服务层设置功能
轿厢照明、风扇节能	○ 一键呼救	无接触控制技术
○ IC 卡功能	○ 停电救援功能	○ 轿厢到站钟
	电动松闸	○ 语音报站

注：标记 "O" 的为选配功能。

哈尔滨 黑龙江省哈尔滨市南岗区闽江路 233 号缤纷假日大厦 18 楼 E 座 电话：(0451) 8231-5191 传真：(0451) 8231-5193	北京 北京市朝阳区东三环南路 98 号高和蓝峰大厦 A 座 601 室 电话：(010) 5718-7421/7406 传真：(010) 5718-7421	大连 辽宁省大连市中山区明泽街 27 号时代广场 A 座 2803 号 电话：(0411) 8258-4100/4101/4102 传真：(0411) 8258-4100-616
石家庄 河北省石家庄市长安区中山东路 39 号勒泰中心 A 座 2502 室 电话：(0311) 8586-6205 传真：(0311) 8586-6205	西安 陕西省西安市长安北路 113 号大话南门壹中心 2110 室 电话：(029) 8781-2893	青岛 山东省青岛市市北区黑龙江南路 2 号万科中心 C 座 1923 室 电话：(0532) 5557-6116 传真：(0532) 5557-6109
济南 山东省济南市历下区经十路 13777 号中润世纪城 13 号楼 401A 室 电话：(0531) 8602-5787 传真：(0531) 8602-5785	郑州 河南省郑州市金水区经三路与东风路交叉口金成国际广场 6 号楼东单元 1805 室 电话：(0371) 5517-8265	武汉 湖北省武汉市江岸区黄孝河路 182 号华中国际广场 B 座 24 层 9-12 室 电话：(027) 8296-9233
合肥 安徽省合肥市庐阳区濉溪路 118 号置地汇丰广场 704 室 电话：(0551) 6421-8002 传真：(0551) 6421-8934	南京 江苏省南京市江宁区松风路 20 号宏茂大厦 906 室 电话：(025) 8622-5496	上海 上海市闵行区吴中路 1779 号万象城 C 栋 8 层 电话：(021) 6485-8600/5160-0150
杭州 浙江省杭州市拱墅区善贤路 4 号创新中国产业园 5 楼 534 室 电话：(0571) 8649-7837 传真：(0571) 8649-7970	长沙 湖南省长沙市韶山北路 431 号东塘瑞府 B 座 935-937 室 电话：(0731) 8990-4553	成都 四川省成都市成华区建设路 55 号华联东环广场 1301 室 电话：(028) 8355-0648
重庆 重庆市渝北区新牌坊金山路 18 号中渝·都会首站 2 栋 404 室 电话：(023) 6320-3876 传真：(023) 6320-3889	南昌 江西省南昌市九龙大道 1177 号绿地博览城 4A 商业办公楼 802 室 电话：(0791) 8385-2158	厦门 福建省厦门市湖里区高崎南五路 222 号航空商务广场 7 号楼 808 室 电话：(0592) 5165-870